

vilo

SPC wall & floor panels



Complementary product range

Our offering includes both SPC walls and flooring solutions, coming together to create a cohesive interior system. The wall panels and SPC floors share identical colour schemes and precise dimensional alignment. This ensures that both products seamlessly work together, forming a uniform, harmonious space. This is the first solution of its kind on the market, offering full compatibility between walls and floors, providing an exceptional aesthetic effect and ease of installation. It's an ideal choice for those who value cohesion, elegance, and a modern approach to interior design.



You can create the perfect Interior



SPC wall panels

30 x 60 cm

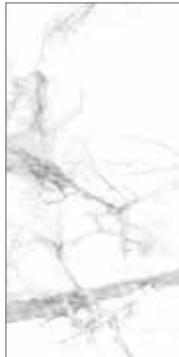

60 x 120 cm



SPC vinyl flooring

60 x 60 cm

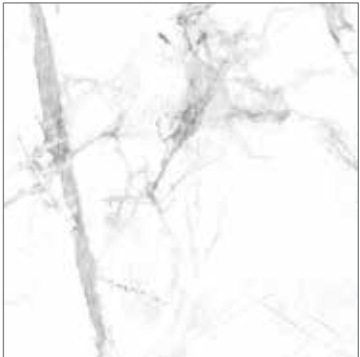

Customised technology

SPC (Stone Polymer Composite) technology combines stone and polymers to deliver exceptional durability and resistance to damage. SPC wall panels feature a rigid composite core that ensures strength and moisture resistance, while the decorative layer, protected by UV coating, maintains a long-lasting aesthetic appeal.

SPC flooring is distinguished by its high wear resistance and durability against scratches and deformation, making it an excellent choice for high-traffic areas. Its composite core provides exceptional sturdiness, while also offering comfort through effective sound and thermal insulation.



Elegance and functionality. The perfect combination

SPC wall and floor panels are 100% waterproof and safe, making them ideal for bathrooms, kitchens, and other residential interiors, as well as commercial spaces.

The attractive designs make these panels suitable for almost any room, transforming the space with a fresh look and feel.

Thanks to their waterproof properties, the SPC panels are ideal for moisture-prone areas like kitchens, bathrooms, and laundry rooms. They also perform well in spaces subject to temperature fluctuations.



SPC wall panels



Colours



Concrete Dust (matte)



Concrete Beige (matte)



Concrete Light (matte)



Rusty (matte)





Calacatta Snow (matte)



Calacatta White (glossy)



Calacatta Black (glossy)



Ash Grey (glossy)



Marble Skin (glossy)



Dark Stone (glossy)





Product features



Easy to install

No specialized tools are required, and installation is intuitive, allowing you to do it yourself. The process is clean, with less dust compared to tiles. No grouting or spacers are needed, and the quick-drying adhesive speeds up the completion..



Easy to work with

SPC panels can be easily cut with a knife to fit various shapes and sizes. They are lightweight, making them easy to transport and install on your own.



Hygienic

Without the need for grouting, SPC panels reduce the risk of mold and fungi growth, keeping your space cleaner and healthier.

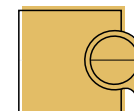

Subtle

At just 0.4 cm thick, SPC panels take up less space than tiles, offering a sleek, minimalistic look without compromising room size.

Easy installation

Installing the panels is intuitive and simple. All you have to do is clean the wall, measure, cut the panels accordingly and stick them directly to the wall using adhesive. You can make changes to the room yourself, quickly and with basic tools. The effect of the interior makeover is impressive and visible immediately upon completion. Detailed installation instructions are available in the package and on **vilohome.com**.

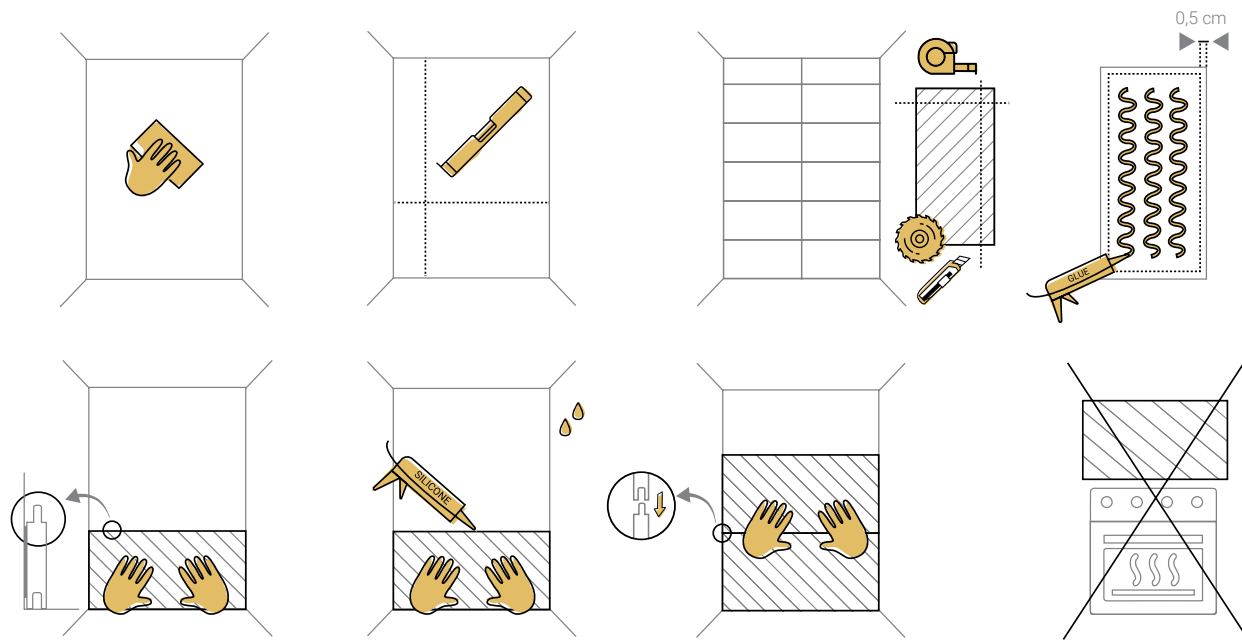

Scan QR code
to watch installation video.



SPC vinyl flooring



Colours



Concrete Dust (matte, embossing)



Concrete Beige (matte, embossing)



Concrete Light (matte, embossing)



Rusty (matte, embossing)





Calacatta Snow (matte, embossing)



Calacatta White (matte, embossing)



Calacatta Black (matte, embossing)



Ash Grey (matte, embossing)



Marble Skin (matte, embossing)



Dark Stone (matte, embossing)





Product features



Drop Lock

The I4F drop lock system makes SPC floor installation quick and simple. Its advantages include:

- Exceptionally tight connection: perfect for kitchens and bathrooms, it resists standing water for up to 24 hours.
- Durable and rigid: allows flooring to be laid without expansion joints at doors for areas up to 10 linear meters (100 m²).
- Faster installation: reduces installation time by 30% compared to fall-down locks.



Water resistant material

SPC vinyl flooring is fully water resistant, making it ideal for kitchens and bathrooms. To prevent water penetration under the panels, it is recommended to glue the flooring in these areas, avoiding moisture buildup and the risk of mold or unpleasant odors. The flooring also features an R10 anti-slip rating, ensuring safety even on wet surfaces.



AC5

Abrasion class

With an AC5/33 rating, SPC vinyl flooring is highly resistant to wear and tear, making it perfect for high-traffic areas such as public buildings. Its durability ensures long-lasting performance in even the most demanding environments.

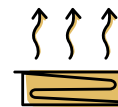

Underfloor heating

This product is compatible with water-based underfloor heating systems, making it a great choice for apartments and homes. Its technical parameters ensure comfort and efficiency when used with underfloor heating.



Micro-Bevel Design

The micro-bevel detail enhances the floor's elegance, creating a seamless, natural look between planks. It reduces the visibility of dirt and dust in the joints, making cleaning and maintenance easier.

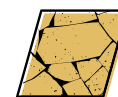

Embossing

Thanks to its tactile texture, panels perfectly mimic natural materials, offering the elegance of stone with the durability and easy maintenance of SPC flooring.

Easy installation

Installing the panels is intuitive and simple. All you have to do is clean the wall, measure, cut the panels accordingly and stick them directly to the wall using adhesive. You can make changes to the room yourself, quickly and with basic tools. The effect of the interior makeover is impressive and visible immediately upon completion. Detailed installation instructions are available in the package and on vilohome.com

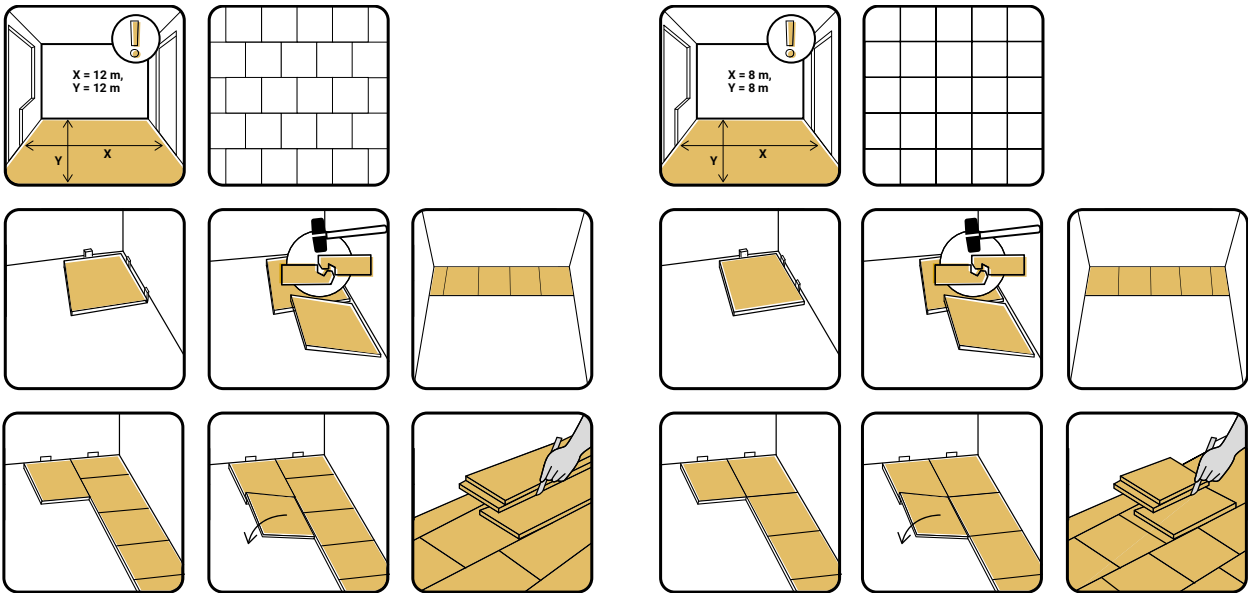

Scan QR code
to watch installation video.





SPC wall panels - overview of decors



Calacatta Snow



Concrete Light



Concrete Dust



Concrete Beige



Rusty



Calacatta White



Ash Grey



Marble Skin



Dark Stone



Calacatta Black

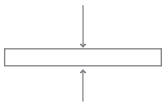

0,4 cm



30x60 cm











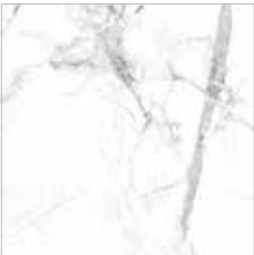

60x120 cm

All colours shown in this publication are examples, and should not be considered original.

SPC vinyl flooring - overview of decors

MATTE

 Calacatta Snow	 Calacatta White	 Ash Grey	 Marble Skin
 Dark Stone	 Calacatta Black	 Concrete Light	 Concrete Dust
 Concrete Beige	 Rusty		

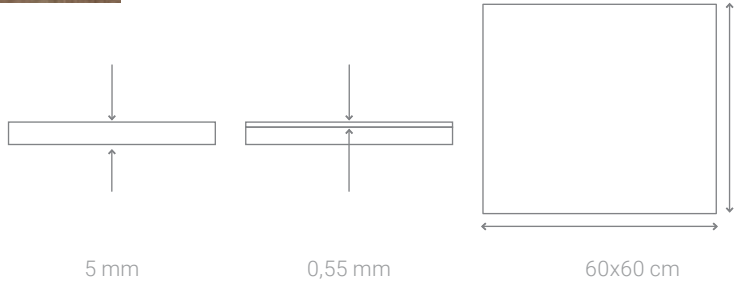

All colours shown in this publication are examples, and should not be considered original.



Design your own interior

VOXBOX is an intuitive interior design tool that allows you to precisely plan your space using SPC panels. With this program, you can easily:

- Visualize your design ideas by selecting the perfect SPC wall and flooring panels for your chosen room. Test different layouts and colour combinations to create a harmonious, cohesive space.
- Adjust details and see how various elements work together in a virtual model before moving forward with the project.

VOXBOX not only facilitates interior arrangement but also lets you experiment with different styles, making it easy to choose the right solutions. SPC wall panels and vinyl SPC flooring are versatile materials that, thanks to their adaptability, give any room a unique and modern character.

SPC panels are not only functional but also aesthetically pleasing, enhancing the style of any space. With **VOXBOX**, designing interiors with these materials becomes effortless, and the results are instantly visible. It's the perfect way to create a space that is both beautiful and durable for years to come.



Design your own interior
with SPC Vilo wall panels
in the **VOXBOX** application
available at vox.pl



vilo



vilohome.com

index: 9038450



909038450#23900#

V. 11.2024